

GEARCHANGE INSTALL

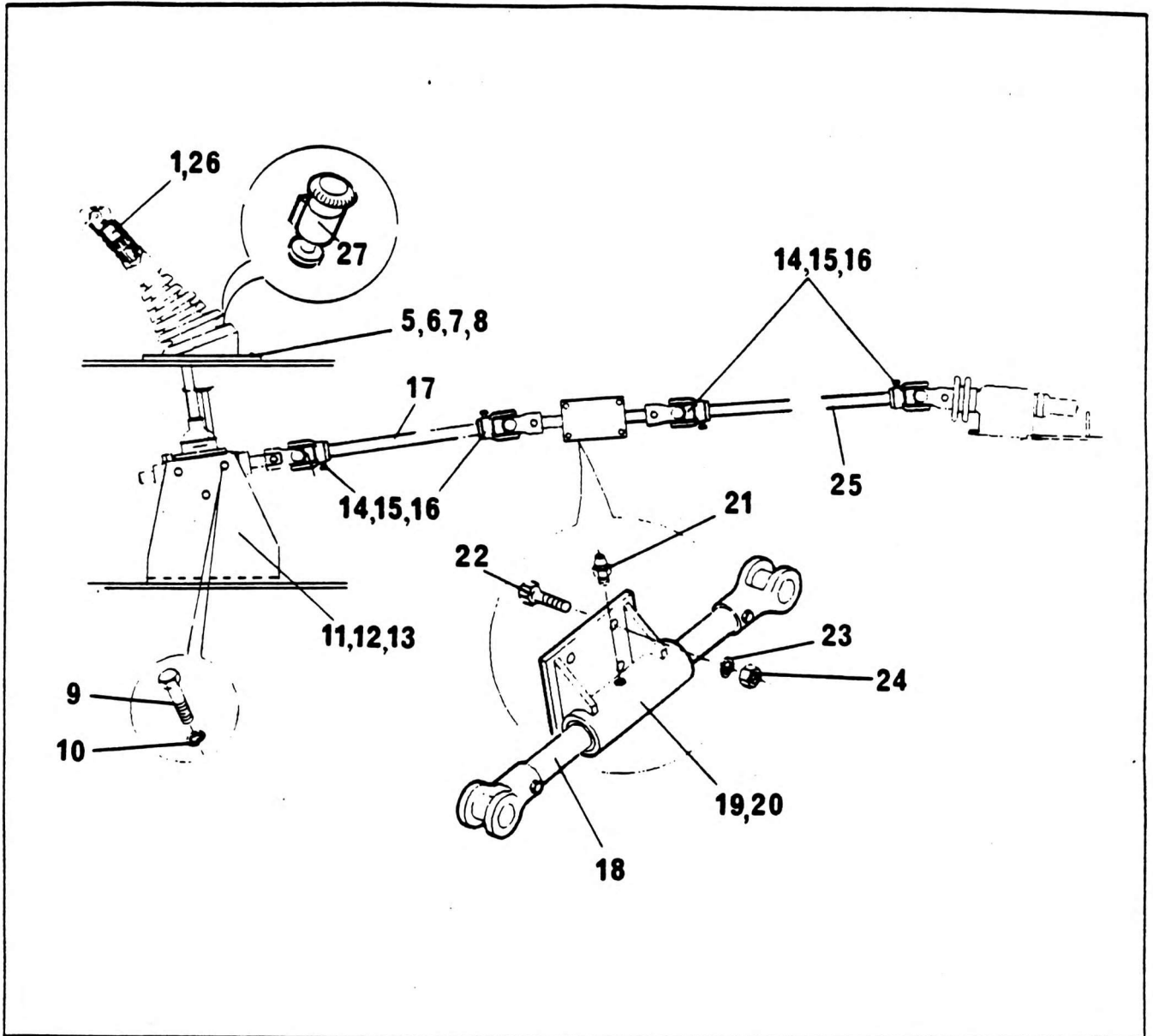

| NO. | PART NO.     | QTY. | DESCRIPTION            | NO. | PART NO.     | QTY. | DESCRIPTION        |
|-----|--------------|------|------------------------|-----|--------------|------|--------------------|
| 1 + | 6-593-990266 | 1    | Changespeed Box        | 18  | 6-810-990205 | 1    | Shaft Mid Bearing  |
| 5   | 6-679-991797 | 1    | Plate Mounting         | 19  | 9527         | 2    | Bush               |
|     |              |      | Gear Change            | 20  | 6-184-991345 | 1    | Bracket Bearing    |
| 6   | 7-126-131153 | 8    | Screw M5 x 20 Long     |     |              |      | Support            |
| 7   | 7-951-130014 | 8    | Washer M5              | 21  | 7-440-000000 | 1    | Grease Fitting     |
| 8   | 7-951-130210 | 8    | Spring Washer M5       | 22  | 7-126-191450 | 4    | Bolt M10 x 35mm Lg |
| 9   | 7-115-160850 | 3    | Capscrew 3/8" x 1" UNC | 23  | 7-951-190014 | 4    | Washer M10         |
|     |              |      |                        | 24  | 7-661-191103 | 4    | Nut M10            |
| 10  | 7-951-190210 | 3    | Washer Spring M10      | 25  | 6-810-990277 | 1    | Shaft              |
| 11  | 6-966-990437 | 1    | Mounting Bracket       | 26  | 2-543-990245 | 1    | Flex Pipe Set      |
| 12  | 7-126-211550 | 1    | Bolt M12 x 40 Long     | 27  | 8789982      | 1    | Cigar Lighter      |
| 13  | 7-951-210210 | 3    | Spring Washer M12      |     |              |      |                    |
| 14  | 7-364-990017 | 4    | Universal Joint        |     |              |      |                    |
| 15  | 7-786-990017 | 8    | Lockscrew              |     |              |      |                    |
| 16  | 7-978-990110 | 1    | Iron Wire              |     |              |      |                    |
| 17  | 6-810-990312 | 1    | Shaft Front            |     |              |      |                    |

+ See further breakdown in this group